

EmulsiFlex Check Valve Manual

Inlet Check Valve

The Inlet Check Valve is a stand-alone assembly comprised of parts 1,2,3,4,5 and 6. It is assembled independent of the Pump Body (8) and is inserted into the Inlet Check Valve Socket (7).

Outlet Check Valve

The Outlet Check Valve is comprised of parts 10,11,12 and 13 and is not a stand alone assembly. It must be assembled with the Pump Body (8) to form a functioning unit.

Disassembly

1. The Pump Body (8) must be held rigidly. Either remove from homogenizer and secure in a vise, or ensure homogenizer is rigidly held.

2. Using a 1-1/2" (39mm) wrench, loosen Screw (2) using smooth, even pressure. Once loose, remove Inlet Check Valve Assembly by hand and set aside. Loosen Check Valve Screw (13) and undo by hand. Do not let parts 10, 11 and 12 fall out as Outlet Screw (13) is removed.

3. Take the Inlet Check Valve Assembly, removed in Step 2, and place vertically in a strong vise, gripping the wrench flat on the Inlet Check Valve Body (6) tightly.

4. Use a 13/16" (21mm) wrench on the Inlet Check Valve Gland Nut (1) to carefully loosen. This part is very tightly assembled. Once loose, undo by hand to fully disassemble.

Assembly

1. Assembly is accomplished by reversing the steps outlined in the Disassembly section above. Torque values must be adhered to as follows:

Check Valve Screw (13) into Outlet Check Valve Socket (9) – 130 ft.lb. / 176 Nm

Inlet Check Valve Gland Nut (1) into Inlet Check Valve Body (6) – 130 ft.lb. / 176 Nm

Inlet Check Valve Assembly (NEW style, dimple in Check Valve Body, 6) into Inlet Check Valve Socket (7) – 130 ft.lb. / 176 Nm

Note: anti-galling paste *must* be applied on check valve body (6, 12) / nut (2, 13) interfaces to help nut (2, 13) slip on check valve bodies.

Inlet Check Valve Assembly (OLD style, cone on Check Valve Body, 6) into Inlet Check Valve Socket (7) – 40 ft.lb. / 54 Nm

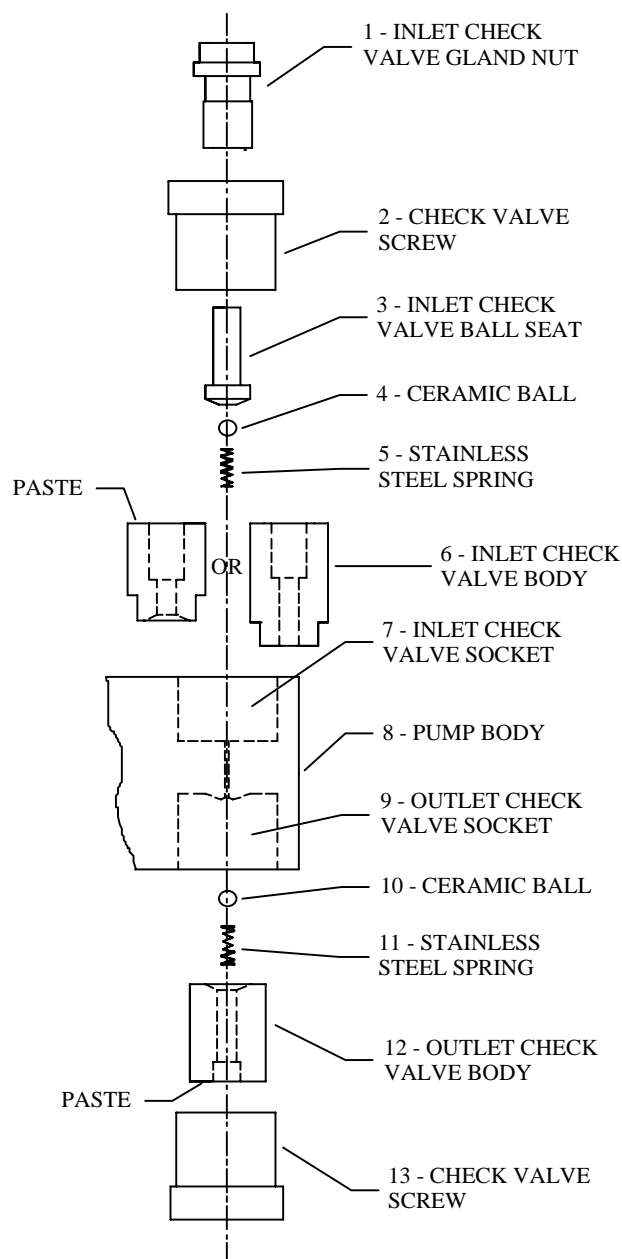

www.avestin.com

AVESTIN, Inc.

2450 Don Reid Drive, Ottawa, ON, Canada, K1H 1E1, e-mail: avestin@avestin.com, website: www.avestin.com

Tel: -613-736-0019, Fax: -613-736-8086, US & CDN customers call toll free: 1-888-AVESTIN (283-7846)

No voice mail: a qualified person will answer your call in the language of your choice: English, Deutsch, Français